

Date: February 1, 2026

Tender Title: "RFQ (Request for Quotation) for Civil Construction & Interior Decoration of ATM booth at Mymensingh RAB-14 HQ.

Tender Ref: "CBBL/GSD/RFQ/2026/0014"

Dear All,
Greetings from Community Bank Bangladesh PLC.!!
Community Bank Bangladesh PLC is the 59th Schedule Bank of Bangladesh. For Civil Construction & Interior Decoration of ATM booth at Mymensingh RAB-14 HQ. BOQ, lay-out (proposed) are attached herewith as your ready reference.

- ✓ Only relevant enlisted vendors shall be eligible for submission of their financial offer.
- ✓ No advance will be allowed in this regard.
- ✓ 10% of the actual payable bill shall be retained at Head Office for 01 (one) year after completion of the works (if work order value is above BDT 50,000.00).
- ✓ All price/ rate should be inclusive of Carrying Charge, Installation Cost and related Materials, VAT and Tax which will be deducted from source during payment of final bill after satisfactory completion of the works.

You are requested to submit (HARD COPY) your financial offer in a closed envelope as per specification within 2.00 P.M. on February 08, 2026. At Bank's discretion, any bidder can be declared as non-responsive if any inconsistency is found or vendor's do not have sufficient strength to carry out the works.

TENDER SUMMARY

1	Tender Reference No	CBBL/GSD/RFQ/2026/0014
2	Date Of Tender Document	01.02.2026
3	Last Date for Submission Of Tender	08.02.2026 at 2.00 P.M.
4	Date Of Opening of Financial Bid	Will be opened through Tender Opening Committee
5	Cost Of Tender Document	Free of Cost

A. General Terms and Conditions:

- 1) **Financial Offer/Price/Quotation:** The quoted price should include applicable VAT & TAX. The rate shall be as per Government circular. The bidder shall have to submit the price in their Company Pad and Envelope.
- 2) **Work Location/Delivery Place:** Mymensingh RAB-14 HQ.
- 3) **Time Of Completion** : 30 [Thirty] days from the date of issuing written work order.
- 4) **Period of Maintenance:** 12 [Twelve] months from the date of issue of final certificate of completion by the authority.
- 5) **Payment Terms:** Payment will be made after each completion the job at actual quantity upon submission of the bill with work order & noc from the deployed location which is duly signed by authorized personnel (Name & Seal, if available). Payment will be made through the Bank Account only.
- 6) **Qualification of Contractor:** The Tenderer must have experience in completion of work(s) of this nature interior decoration works in Banking Industry of 02 (two) schedule Banks which must be executed by the contractor during last two financial years. All experiences must be backed by with proper documentation (i.e. work order, completion certificate) from respective banks. Need to submit with price quotation.
- 7) **Purchaser's Right:** The Purchaser reserves the right to accept/ cancel/ reject any or all offer without assigning any reason. Considering the Experience, quality and other factors the purchaser is not obliged to purchase the lowest offer at all. The purchaser reserves the right to share the Bidder's response to this RFQ with its advisors and purchaser Business Units. Purchaser reserves the right to conduct negotiations with one or more Bidder and / or accept the Bid without any negotiations.



**General Services Division
Head Office, Dhaka**

- 8) **Required Content of the Quotation:** Quotation must be submitted as per prescribed form as instructed below:
- i. Proposal must be addressed for "Chairman Purchase Committee" of Community Bank Bangladesh PLC.
 - ii. Complete Proposal / Offer must be signed with date by the authorized representative of the company.
 - iii. Must mention the subject line "RFQ (Request for Quotation) for Civil Construction & Interior Decoration of ATM booth at Mymensingh RAB-14 HQ. RFQ: "CBBL/GSD/RFQ/2026/0014" in top of the Envelope.
- 9) **Quotation Validity:** Offer validity period shall be at least for 03 (three) months from the Quotation submission/ closing date. Details discussion/terms & condition will be available in Work Order (WO).
- 10) **Disqualification:** Manipulation or any kind of unusual approach or failure to submit the proposal/ offer within stipulated time frame will be treated as "Disqualification" to attend in the bidding.
- 11) **Sample/Presentation of Company Profile:** Bank may ask mock test/ presentation of bidder's present and previous works before selection of any vendors which is FOC (Free of Cost).
- 12) In the event of supply of any items, which do not match with the required specification, quantity or sample's quality or is of substandard quality, the Bank reserves the right for outright rejection of the works/product, and the supplier will have to do the works/supply the product again with their own cost with acceptable quality within 30 (thirty) days from the date of rejection.

Regards

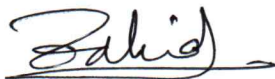

Md. Zahid Ibne Anwar
Head of GSD (Current Charge)
Community Bank Bangladesh PLC.



 Community Bank <small>• Trust • Security • Progress</small> Proposed BOQ for Civil Construction & Interior Decoration of ATM booth at Mymenshingh RAB-14 HQ .		
Sl.	Description of works	Amount in BDT (including VAT & Tax)
1	CIVIL Works	
2	Interior Works	
3	Paint Works	
4	Electrical Works	
5	Furniture & Others Related Works	
Grand Total		

In word:

Name of the Bidder :

Contact Person :

Contact Number :

Seal & Sign:



[Signature]

[Signature]



Community Bank

• Trust • Security • Progress

Proposed BOQ for Civil Construction & Interior Decoration of ATM booth at Mymensingh RAB-14 HQ .

Item	Description	Unit	Quantity	Rate(Including VAT & Tax)	Total Amount (Including VAT & Tax)
A. CIVIL Works					
1	Site Preparation, Dismantling & Cleaning Works: Existing Boundary wall dismantling & same as finishing, Tree Cutting, Perking Tiles & CC dismantling, Lamp post shifting & others related works complete as per direction.	job	1		
2	Soil Cutting work For Foundation & Electric Main Line: working instrument, labor supply & work complete as per requirement of design	cft	450		
3	Sand filling work: working instrument, labor supply & work complete as per requirement of design	cft	200		
4	3" Flat Brick Soling Works at Plinth Level: Providing and laying 3 inch thick flat brick soling at plinth level with well-burnt bricks laid flat, properly aligned and compacted on prepared surface, including filling joints with sand, watering, ramming, curing and all materials, labor and equipment complete as per specifications.	sft.	190		
5	Sub soil peripheral Brick Wall (10") boundary works upto plinth level (depth approx 2'~3'): Bricks, sand, cement, working instrument & labor including material work complete as per requirement.	cft	60		
6	5" THICK BRICK WORK : Brick work with 1st class bricks of one brick width [±5"] in cement mortar (1:4) in exterior or interior walls in/c filling the interstices with mortar, racking out joints cleaning and soaking the bricks at least for 24 hours before use and necessary scaffolding, curing at least for 7 days etc. complete in all respect as per design drawing and direction of Consultant / Bank Authority.	sft	200		
7	PLASTER WORK: Minimum 12mm thick cement sand (F.M. not below 1.2) plaster (1:6) with fresh cement (conforming to BDS232) to both inner and outer surfaces of walls, finishing corners and edges, screening and washing sand, preparing the masonry and others surfaces by cleaning and washing, curing completed plaster for at least 10 (ten) days including supply at site of all necessary materials, scaffoldings, water, electricity and also other charges etc., all complete as per approval and directions of the consulting architect and full satisfaction of the Bank authority.	sft	700		
8	Mirpur Ceramics Wall Clay Cladding : Supply and installation of Mirpur Ceramics wall clay cladding on wall surfaces, same as existing as per approved drawings and manufacturer's specifications, including all necessary sub-frame, fixings, accessories, cutting, jointing, alignment, cleaning and completion, measured in square feet. (Same as Existing)	sft	60		



Item	Description	Unit	Quantity	Rate(Including VAT & Tax)	Total Amount (Including VAT & Tax)
9	Cement concrete work (3" depth) : In 1:3:6 mix proportion in slabs on plinth level using 20mm down graded brick chips, medium sand (F.M. 1.5) and cement including compacting and curing, etc. all complete as per drawing, specification and instruction of the Engineer-in-charge.	cft	60		
10	RCC works for Column & Beam Including Shuttering: (4x16mm Dia Main Rod & 10mm Dia Ring) 60g rod, 24 nos wire, working instrument & labor; supply including material work complete work complete Deformed high strength reinforcing steel {A 615 having FY Min. 415 Mpa (60 Ksi)} work of any size with standard round bars including supply of 24 BWG black wire, straightening fabrication, bending removal of rusts protective coating, if any,, and loose scale and proper placement in position in all floors as per drawing and instruction of the Engineer-in-charge.(Management will be given as per standard weight of ASTM specification). (BSRM/Equivalent)	cft	90		
11	RCC works for Slab & Lintel Including Shuttering: (10mm Dia Rod Double Layer) 60g rod, 24 nos wire, working instrument & labor; supply including material work complete work complete Deformed high strength reinforcing steel {A 615 having FY Min. 415 Mpa (60 Ksi)} work of any size with standard round bars including supply of 24 BWG black wire, straightening fabrication, bending removal of rusts protective coating, if any,, and loose scale and proper placement in position in all floors as per drawing and instruction of the Engineer-in-charge.(Management will be given as per standard weight of ASTM specification). (BSRM/Equivalent)	cft	70		
12	Mirror Polish Tiles (China-2'x2') : Supplying, fitting and fixing of homogeneous mirror polish glazed floor tiles of 600 X 600 mm, CHINA Origin on 20 mm thick cement mortar (1:4) base including cutting by electric disk cutter and laying tiles in proper way in/c chipping or dismantling of existing floor if necessary and finishing with care etc., complete in all respect as per design & direction of the Bank authority.	sft.	170		
13	Pavment Tiles Work: Supply and laying of approved pavement tiles of specified size, thickness and color on prepared base as per drawings and specifications, including surface preparation, bedding layer, cutting, joint filling, alignment, leveling, cleaning and completion(Same as existing)	sft	20		
Sub-Total Amount in BDT For civil works =					



Item	Description	Unit	Quantity	Rate(Including VAT & Tax)	Total Amount (Including VAT & Tax)
B. Interior Works					
1	TEMPERED GLASS DOOR Supplying, fitting and fixing imported Frameless Tempered Glass Door having 10 mm thickness with all foreign made hardware of best quality available viz. Stainless steel handleless concealed auto-closer, stopper, locking arrangement complete in all respect as per design, drawing and direction of Architect/Authority. Size : 3'-0" W X 7'-6" or Custom Size.	Nos	1.00		
2	FRAMELESS GLASS PARTITION Supplying, fitting and fixing 10 mm thick clear float glass partition, upper and lower sides are fixed with 1/2" aluminum U-Channel section, all visible and exposed surfaces must be bevelled or diamond finished by machine, complete in all respect as per design, drawing and direction of Architect/Authority.	sft	36.00		
4	Low Height Partition (4" Thick) Supply, fitting & fixing low hweight partition made of 12 mm partex board fixed over metal frame work at a 6' hieght from floor and 3 coats of plastic paint over primer coat, putty, racking out joints etc. all complete as per design, direction and full satisfaction of Engineer.	sft	30.00		
5	PVC BOARD CEILING: Supply, fitting & fixing of 600mm X600mm X 15 mm PVC board (China) false ceiling over powder coated T-bar of section 25mmx38mm and L-angle of section 25mmx25mm at edges, at 600mmx600mm grid suspended ceiling by rowel plug iron angles 12 SWG G.I. wire, screws, hooks, nails etc. maintaining straight lines and desired finished level at bottom face with vertical or beams by electric drill machine damage if any during the materials, accessories, scaffolding, labor for Installation etc. all complete as per Bank standard and full satisfaction of the Bank authority.	Sft	160.00		
	ROLLING SHUTTER [SHEET] Supply, fitting & fixing steel manually operated rolling shutter made of strips imported G.P. sheet of approved thickness and quality including concealed type locking arrangement and paint finish etc. complete in all respect as per design drawing and direction of Architect/ Authority.	sft.	80		
	Aluminium Composite Panel Work: Supply, Fabrication and Installation of 4.0 mm PVDF (Fluorocarbon paint finish) coated Aluminium composite panel of approved color and quality, cladded on standard and necessary aluminium or galvanized framing with all necessary accessories. All complete as per design, direction and full satisfaction of the Engineer in charge/Bank authority. Materials Specification: Thickness : 4.0 mm(Aluminium Core 0.5mm + Anti toxin (PE)Core 3.0mm + Aluminium Core 0.5mm); Frame: 46.0mmx20.0mm Aluminium rectangular box (Mill finish); Fitting angel : 20.0mm x20.0mm (Bronze),Thickness: 1.2mm	sft	90		
Sub-Total Amount in Tk. For Interior Works =					



Item	Description	Unit	Quantity	Rate(Including VAT & Tax)	Total Amount (Including VAT & Tax)
C. Paint Works					
1	Weather Coat Painting works (to outside walls) Providing and applying Acrylic Emulsion paint finish to Plaster surfaces of approved make, best quality, colour, texture and shade delivered from authorized local agent of the manufacturer in a sealed container, in two coats (surface and finish acceptable to the Bank must be achieved by the contractor within two coats and any additional coats if required shall be at the cost of the contractor), including preparing existing surfaces	sft	400.00		
2	ACRYLIC EMULSION PAINT Providing and applying Acrylic Emulsion paint finish to Plaster surfaces of approved make, best quality, colour, texture and shade delivered from authorized local agent of the manufacturer in a sealed container, in two coats (surface and finish acceptable to the Bank must be achieved by the contractor within two coats and any additional coats if required shall be at the cost of the contractor), including preparing existing surfaces	sft	450.00		
3	Enamel PAINT Providing and applying enamel paint finish wherever applicable, best quality, colour, texture and shade delivered from authorized local agent of the manufacturer in a sealed container, in two coats (surface and finish acceptable to the BANK must be achieved by the contractor within two coats and any additional coats if required shall be at the cost of the contractor), including preparing existing surfaces	sft	50.00		
Sub-Total Tk. for Paint works =					
D. Electrical Works					
1	LED PANEL LIGHT FITTING Foreign made approved type down light shade [reflector] with minimum 12 watt LED light in/c supply of all necessary consumable materials, compatible to local voltage variation, complete in all respect in/c testing & commissioning, as per design, drawing and direction of Authority. [CONCEALED / SURFACE MOUNTED - 6"X6" SIZE], Brand: ENERGYPAC /TACHI/OPEL/ENERGY+	NOS	12		
2	PVC PIPE/C PVC Flexible pipe /PVC Channel WORKS Supplying, fitting and fixing of following water grade PVC pipes orPVC channel with necessary group cutting, bend,joint box, ceilling rose ,clamp,fixing materials and other accessories to complete in all respect as per design drawing and direction of authority.				
i)	PVC pipe ¾" dia	Rft.	50		
ii)	PVC pipe ¾" dia Flexible pipe	Rft.	50		
ii)	1.5"dia CPVC pipe including Bend & Socket for Underground Electric Main Line	Rft.	300		
3	Cables Works				
i)	1x 1.5 rm BYA	Rft.	250		



[Handwritten signature]

Item	Description	Unit	Quantity	Rate(Including VAT & Tax)	Total Amount (Including VAT & Tax)
ii)	1x 2.5 rm BYA	Rft.	300		
iii)	1x 4 rm BYA	Rft.	150		
iv)	1x 10 rm BYA Main line wiring	Rft.	650		
v)	(2.5) RE BYA(Green) wire(BRB)	Rft.	150		
4	ELECTRICAL SOCKET OUTLETS Supplying, fitting and fixing 240V, single phase following socket outlet in/c wiring conceals/surface with necessary wiring through water grade PVC pipe/channel or required size in/c supply of switches, switch box, ebonite cover, ceiling rose etc. Complete in all respect in/c testing & commissioning, as per design, drawing and direction of Authority.				
i)	5A,3 Gang (1way) Switch	Pcs.	3		
ii)	20 AMP DP Switch	Pcs.	2		
iii)	15A, 3 Pin Scket Round Scket	Pcs.	1		
iv)	13A, 3 Pin Scket Multi Scket	Pcs.	8		
v)	Mk Steel Bos(3"x3"x2")	Pcs.	15		
5	MCCB/MCB's Supply and installation of following SP (240V grade) TP (500 V grade) MCB/MCCB" in pre installed distribution board in/c connection with cable, cable socket, nut bolts, PIB tape etc. complete in respect providing necessary consumable in/c testing & commissioning as per design, drawing and direction of Authority.				
i)	SD Board(Havels size 12" x 16")	Pcs.	1		
ii)	10 ~32 AMP SP MCB (Legrand from Energypac)	Pcs.	6		
iii)	63 AMP DP MCB (Legrand from Energypac)	Pcs.	1		
6	EARTHLING ARRANGMENT(0 to 0.5 volt): Supplying and installation of 150' depth 1-½" dia G.I. pipe earth electrode by tube well sinking method including of 2 SWG HDBC earthing lead from the bottom of earth electrode to the earthing bar of distribution board. Making an earth inspection pit of size 20" x 20" x 18" inside clear. Bottom of pit shall be " thick B.C.C. work and four side wall shall be 5" thick brick wall with 1" plastering and 3" thick R.C.C. cover slab. The top end of the electrode shall be 6" above from the bottom C.C. work. Complete in all respect in/c testing & commissioning etc. all per existing samples, choise, design, drawings, directions and ful satisfaction of the consulting architect/Bank Authority. Note: 1. Voltage between neutral and earth [Inductive voltage] must be less than 1 volt. 2.The total arrangement must be theft proof as per site condition.	Nos	1		
Sub-Total Amount in Tk. For electrical works =					



Item	Description	Unit	Quantity	Rate(Including VAT & Tax)	Total Amount (Including VAT & Tax)
E.Furniture & Others Related Works					
1	OFFICER TABLE: Supply, fitting & fixing of work station Table (48"x24") made of Melamine laminated chip board & MS Framing Approved colour/quality as required including slot on table Top for cable passing ,and best quality hardware materials etc. all complete as per design, direction and full satisfaction of Bank Authority.	NOS	1.00		
2	Mobile Drawer Unit – 3 Drawers: Supply, fitting, and fixing of mobile drawer unit (side unit) consisting of 3 drawers, fabricated from laminated board of approved make, color, and quality.Heavy-duty telescopic drawer channels for smooth operation.Central locking system for all three drawers (with 2 keys).All materials, workmanship, and installation shall be of the best quality, and the entire unit shall be delivered and installed to the complete satisfaction of the Bank Authority, in accordance with design, direction, and approval.	NOS	1.00		
3	OFFICER CHAIR: Supply, fitting and fixing of imported High Back Cluster wheel, With Arm Rest, Head rest, Fabric / PU upholstery, Mesh Back, Back adjustable, height adjustable , Caster Mounted (Revolving), Approved Color, Durable Upholstery, as per design & direction of Architect.[Sample should be subject to approval]	NOS	1.00		
4	OFFICER VISITOR CHAIR: Supply, fitting and fixing of imported High Back Cluster wheel, With Arm Rest, Head rest, Fabric / PU upholstery, Mesh Back, Back adjustable, height adjustable , Caster Mounted (Revolving), Approved Color, Durable Upholstery, as per design & direction of Architect.[Sample should be subject to approval]	NOS	2.00		
5	Low Height Cabinet:(Depth-2'-0" H-4'-0") Supply,Fitting & fixing of low height cabinet Built-in-self made by 18mm melamine board with best quality hardware materials etc.	sft.	32.00		
6	Guard Tool: SS Structure with rexin	NOS	1.00		
7	PVC DOOR MAT Supplying, fitting and fixing best quality imported PVC mat [Dust catcher] complete in all respect as per direction of Consultant / Bank Authority.	sft	20.00		
Sub-Total Amount in Tk. For Furniture & Others Related Works =					
Grand Total =					



[Handwritten signature]

[Handwritten signature]

MAIN ROAD

Sidewalk

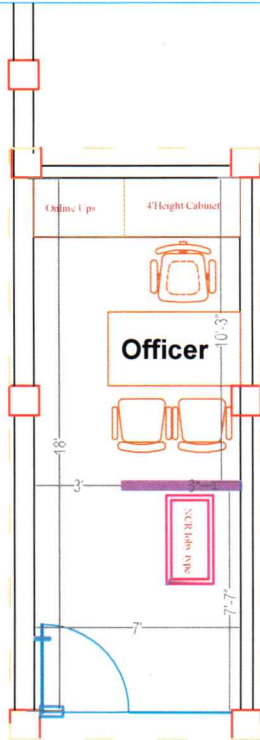

Waiting

Guard Room

RAB-14, HQ ENTRY

Sidewalk

I PROJECT I
Proposed RAB-14 HQ
Mymenshingh ATM Booth
Community Bank Bangladesh PLC.

MAIN ROAD

Sidewalk

Mosque +350ft Distance for Electric Line

**Proposed
ATM Location**

Waiting

Guard Room

RAB-14, HQ ENTRY

Sidewalk

| PROJECT |
Proposed RAB-14 HQ
Mymenshingh ATM Booth
Community Bank Bangladesh PLC.

RAB-14 HQ, Mymensingh

